

| COMPONENT | MATERIAL AND FINISH | |
|----------------|---|--|
| BODY & CONTACT | BeCu, ASTM B196, UNS C17300 | GOLD PLATE, MIL-G-45204, TYPE 1, GRADE C, CLASS 1 |
| INSULATOR | PTFE, ASTM D1710, TYPE I, GRADE 1, CLASS A | |

PART NO. MMSP-5597

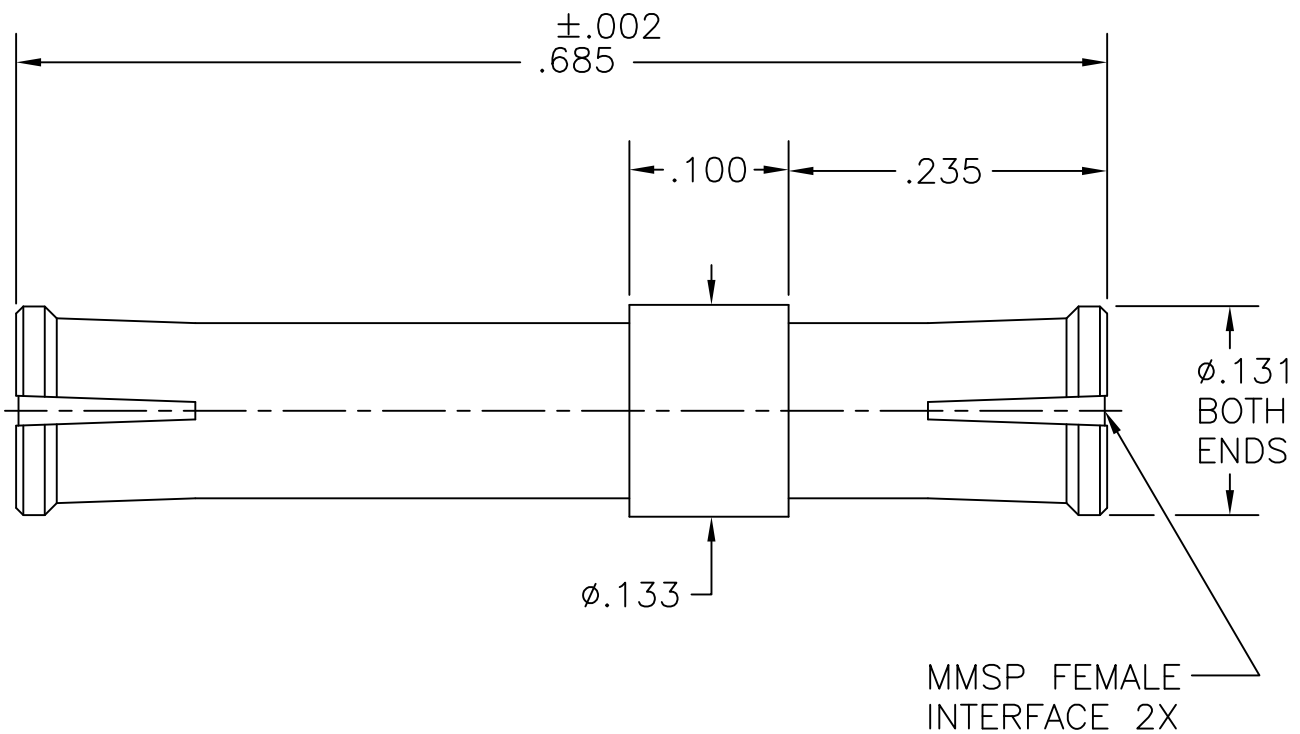

OUTLINE DRAWING

| | | | |
|--|--|--|--------------------|
|  | MICRO-MODE PRODUCTS, INC. <i>The Reliable Connection to the Future</i> | El Cajon, CA 92020 ph 619.449.3844 www.micromode.com | CAGE CODE 15907 |
|--|--|--|--------------------|

| | | | |
|---------------------------------------|--|-----------|----|
| ASSY PROCEDURES: | MMSP FEMALE (.685 OAL) BLINDMATE INTERCONNECT | | |
| INSERTION/EXTRACTION TOOL: MMTL-15363 | PART NO. | REVISION | |
| SHEET 1 OF 1 | OL5597 10-16-02 MP RF | MMSP-5597 | 01 |