

OUTLINE DRAWING

PART NO. 1202-2-0455-000 XG

SMA FEMALE
INTERFACE PER
MIL-STD-348

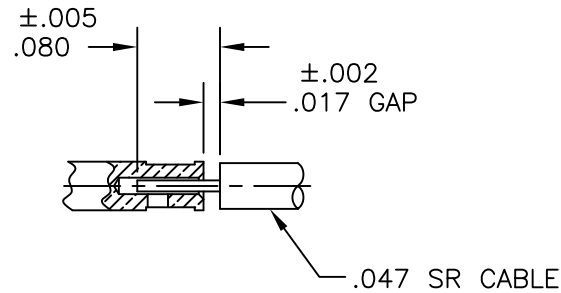
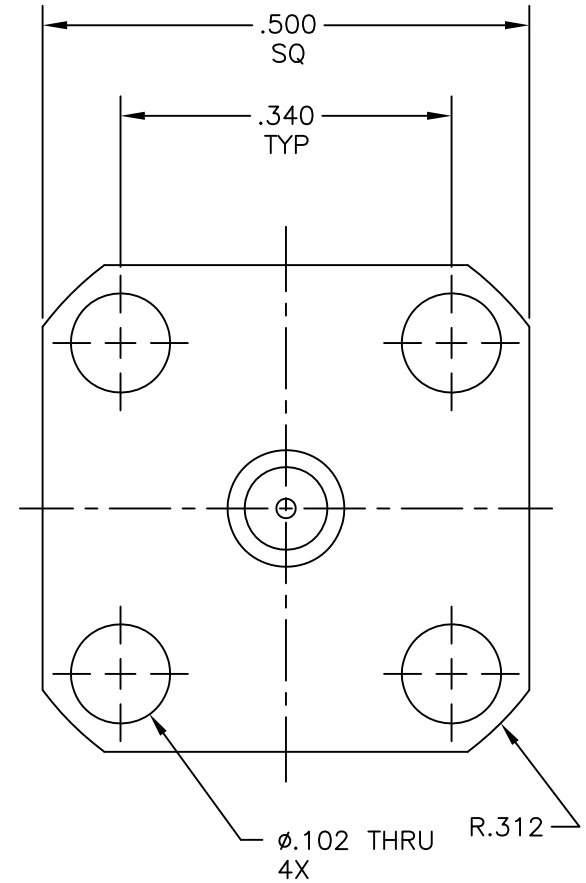
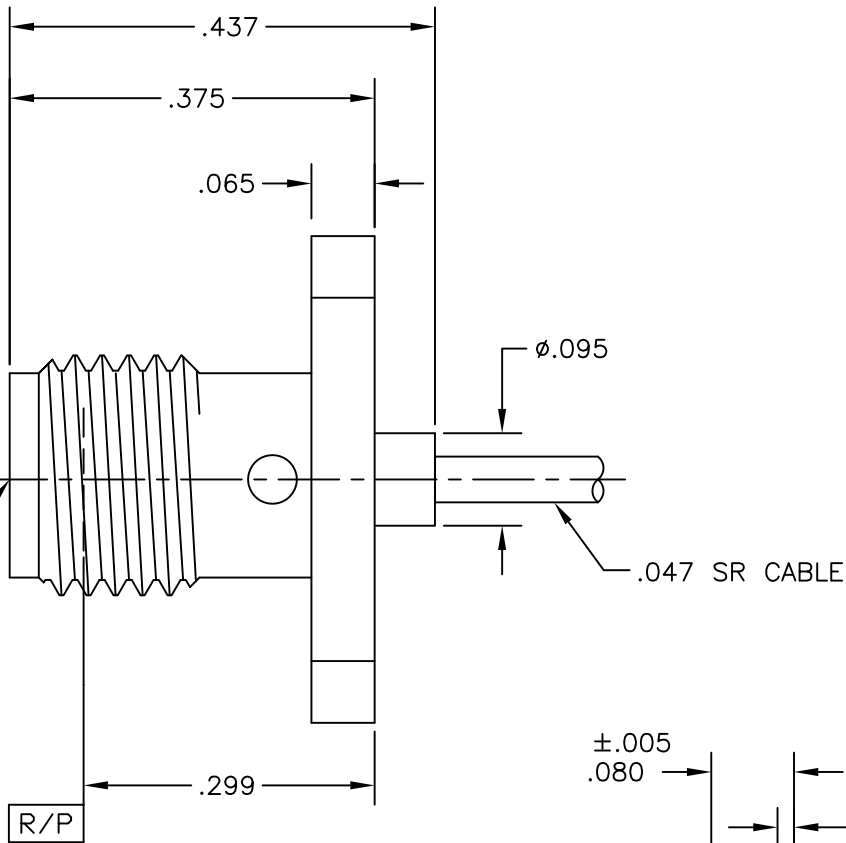

CABLE PREP DETAIL

COMPONENT	MATERIAL & FINISH		MICRO-MODE PRODUCTS, INC. <i>The Reliable Connection to the Future</i>		El Cajon, CA 92020 ph 619.449.3844 www.micromode.com	CAGE CODE 15907
CONTACT	BeCu, ASTM B196, UNS C17300	GOLD PLATE, MIL-G-45204, TYPE 1, GRADE C, CLASS 1	ASSY PROCEDURES: 1202-2-0455-000 XG		SMA FEMALE, 4 HOLE FLANGE TO .047 SR CABLE	
INSULATOR	PTFE, ASTM D1710, TYPE I, GRADE 1, CLASS A		INSERTION/EXTRACTION TOOL: N/A			
BODY	303 CRES, ASTM A582	GOLD PLATE, MIL-G-45204, TYPE 1, GRADE C, CLASS 1	PART NO.		REVISION	
EPOXY	SIGMA PLASTRONICS VARY FLEX #1		SHEET 1 OF 1 OL1202... 9-20-83 KM AK		1202-2-0455-000 XG F	

PART NO. 1202-2-0455-003 XG | OUTLINE DRAWING