

**MOUNTING GUIDELINES FOR MMSP-4248**

THE ABOVE DIMENSIONS ARE  
GUIDELINES ONLY. CHANGES  
MAY BE REQUIRED DUE TO  
DIFFERING MATERIALS,  
PROCESSES, TYPE OF BRAZE,  
SOLDER OR EPOXY.

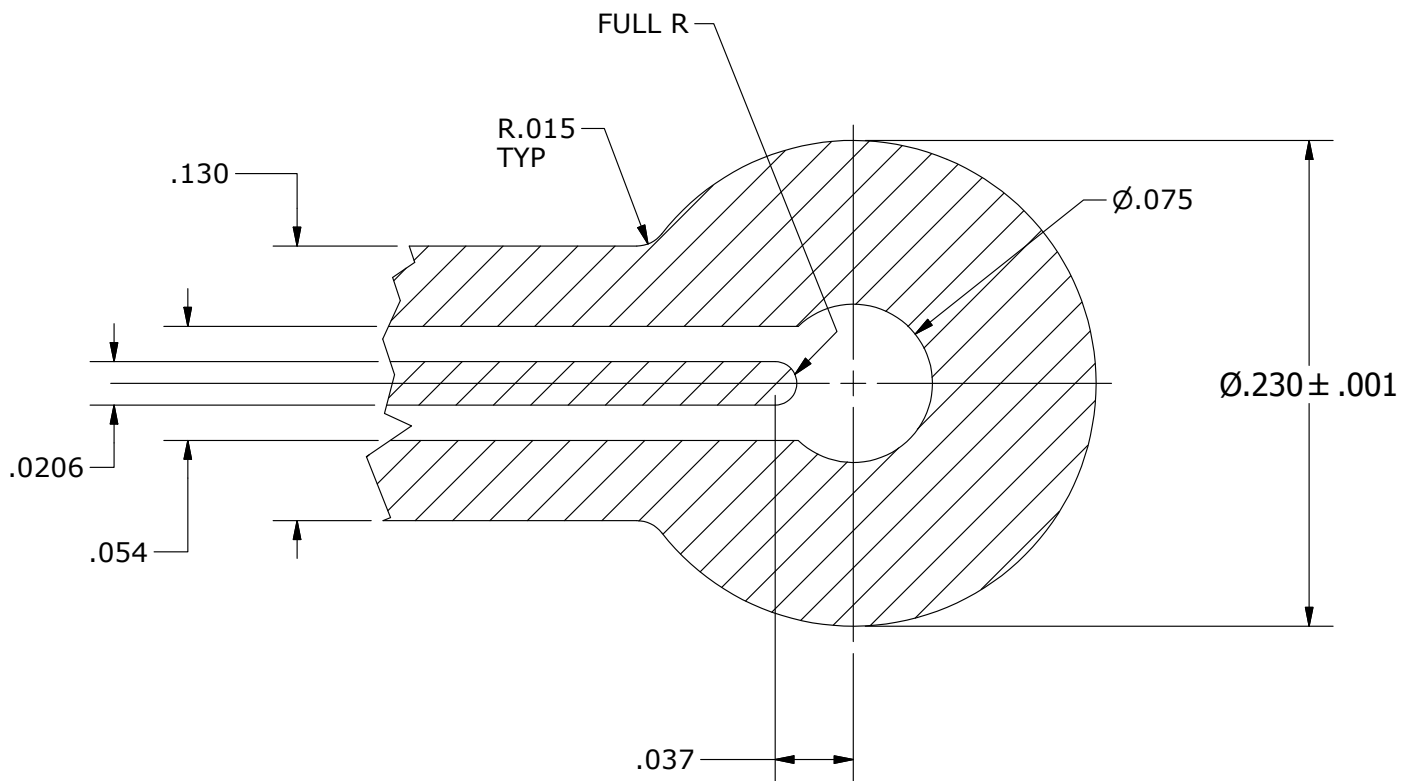

**MICRO-MODE PRODUCTS, INC.**  
*The Reliable Connection to the Future*

El Cajon, CA 92020  
ph 619.449.3844  
www.micromode.com

CAGE CODE  
15907

REF: MMAP-5139

DEFAULT TOLERANCES:  $.XXXX \pm .0010$   
 $.XXX \pm .005$   
 $.XX \pm .01$

**MOUNTING GUIDELINES FOR  
MMSP-4248**

PART NO.

**MMAP-14980**

REVISION

—

SHEET 1 OF 1

OL14980

2/23/2016

SE